

CONNECTORS :

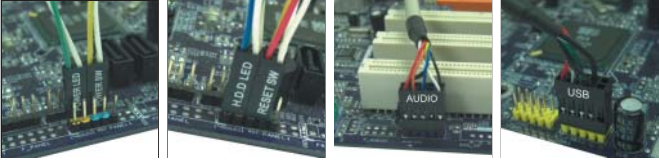

Please refer to your motherboard user manual for correct socket location.
These photos are for reference only.

FDD (OR OTHER 3.5" PRODUCTS) :



1.Remove both side panels. Unscrew the button-lock anti-clockwise.



2.Remove FDD tray.



3.Slide the FDD into the tray.



4.Align the screw holes and fasten the screws.



5.Put the FDD tray back to the chassis.



6.Secure the tray with the button-lock.

HDD :

How to install 5.25">3.5" anti-vibration set.



- One pair of HDD bracket
- 4x M3x6 (silver)
- 4x 6#32 (black)



1. Install the HDD bracket to the HDD using 6#32 (black) screws on both sides



2. Place the HDD into a 5.25" bay



3. Secure the HDD with the M3x6 (silver) screws

When install behind a 12cm fan.

